

**Napac,
Inc.**



***FLANGED
FITTINGS***

Flanges and Accessories
ANSI B16.1
Class 125/250

FLANGE DETAILS - Class 125

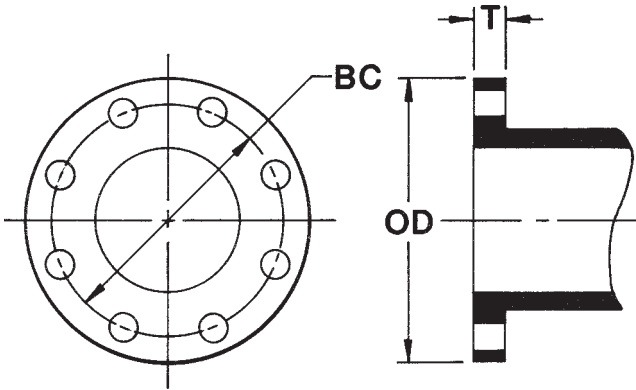

Size	O.D.	B.C.	T	Bolt Hole Dia.	Bolt Dia. & Length	No. of Bolts
2	6.00	4.50	5/8	3/4	5/8 x 2 1/2	4
2 1/2	7.00	5.00	11/16	3/4	5/8 x 2 1/2	4
3	7.50	6.00	3/4	3/4	5/8 x 2 1/2	4
4	9.00	7.50	15/16	3/4	5/8 x 3	8
5	10.00	8.50	15/16	7/8	3/4 x 3 1/2	8
6	11.00	9.50	1	7/8	3/4 x 3 1/2	8
8	13.50	11.75	1 1/8	7/8	3/4 x 3 1/2	8
10	16.00	14.25	1 3/16	1	7/8 x 4	12
12	19.00	17.00	1 1/4	1	7/8 x 4	12
14	21.00	18.75	1 3/8	1 1/8	1 x 4 1/2	12
16	23.50	21.25	1 7/16	1 1/8	1 x 4 1/2	16
18	25.00	22.75	1 9/16	1 1/4	1 1/8 x 5	16
20	27.50	25.00	1 11/16	1 1/4	1 1/8 x 5	20
24	32.00	29.50	1 7/8	1 3/8	1 1/4 x 5 1/2	20

All dimensional data in inches and lbs.

DESIGNATION of OUTLETS In accordance with ANSI B16.1

REDUCING TEES

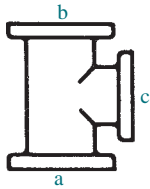

REDUCING ON OUTLET

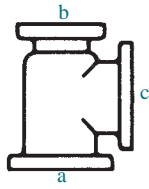

REDUCING ON ONE RUN

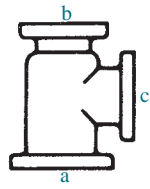

REDUCING ON ONE RUN AND OUTLET

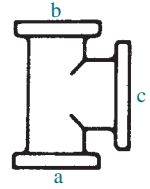

REDUCING ON BOTH RUNS (BULLHEAD)

REDUCING LATERAL

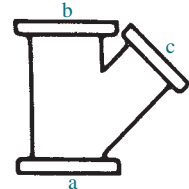

REDUCING ON BRANCH

The largest opening establishes the basic size of a reducing fitting. The largest opening is named first, except for bullhead tees, which are reducing on both runs, and for double branch elbows where both branches are reducing. The outlet is the largest opening and named last in both cases.

In designating the openings of reducing fittings, they should be read in the order indicated by the sequence of the letters a, b, c.

UNITED BRAND FITTINGS

Our dedication to the mechanical piping industry has given us the opportunity to provide you with a quality line of flanged fittings exceeding the competition. Manufactured from high strength grey cast iron and ductile iron, our Flanged Fittings Series are available in 1" - 24" sizes in a variety of elbows, tees, crosses, laterals, reducers, and blind flanges. All are manufactured in accordance with ANSI B16.1, and all are available with special rust inhibitive primers and epoxy coatings.

ORDERS FAX 800-807-2214

ELBOWS

ANSI B16.1 Class 125

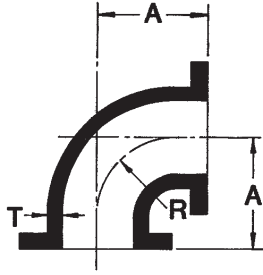

SERIES 10
90°

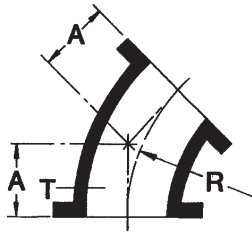

SERIES 11
45°

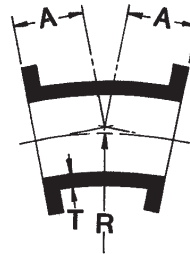

SERIES 12
22 1/2°

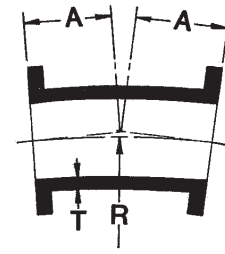

SERIES 13
11 1/4°

Size	90° Elbow				45° Elbow				22 1/2° Elbow				11 1/4° Elbow				T	
	Part No.	A	R	Wgt.	Part No.	A	R	Wgt.	Part No.	A	R	Wgt.	Part No.	A	R	Wgt.		
2	10F-0202-G	4.5	3.0	14	11F-0202-G	2.5	2.4	12	-	-	-	-	-	-	-	-	-	.31
2 1/2	10F-025025-G	5.0	3.5	19	11F-025025-G	3.0	3.6	17	-	-	-	-	-	-	-	-	-	.31
3	10F-0303-G	5.5	4.0	25	11F-0303-G	3.0	3.6	20	12F-0303-G	3.0	7.6	20	13F-0303-G	3.0	15.25	20	-	.38
4	10F-0404-G	6.5	4.5	45	11F-0404-G	4.0	4.8	40	12F-0404-G	4.0	10.06	40	13F-0404-G	4.0	20.31	40	-	.50
5	10F-0505-G	7.5	5.5	52	11F-0505-G	4.5	6.0	45	-	-	-	-	-	-	-	-	-	.50
6	10F-0606-G	8.0	6.0	65	11F-0606-G	5.0	7.3	55	12F-0606-G	5.0	15.06	55	13F-0606-G	5.0	30.50	55	-	.56
8	10F-0808-G	9.0	7.0	105	11F-0808-G	5.5	8.4	90	12F-0808-G	5.5	17.62	90	13F-0808-G	5.5	35.50	90	-	.62
10	10F-1010-G	11.0	9.0	165	11F-1010-G	6.5	10.9	130	12F-1010-G	6.5	22.62	135	13F-1010-G	6.5	45.69	135	-	.75
12	10F-1212-G	12.0	10.0	235	11F-1212-G	7.5	13.3	195	12F-1212-G	7.5	27.62	205	13F-1212-G	7.5	55.81	205	-	.81
14*	10F-1414-D	14.0	11.5	290	11F-1414-D	7.5	12.06	220	-	-	-	-	-	-	-	-	-	.66
16*	10F-1616-D	15.0	12.5	370	11F-1616-D	8.0	13.25	280	-	-	-	-	-	-	-	-	-	.70
18*	10F-1818-D	16.5	14.0	450	11F-1818-D	8.5	14.50	325	-	-	-	-	-	-	-	-	-	.75
20*	10F-2020-D	18.0	15.5	580	11F-2020-D	9.5	16.88	430	-	-	-	-	-	-	-	-	-	.80
24*	10F-2424-D	22.0	18.5	900	11F-2424-D	11.0	18.12	630	-	-	-	-	-	-	-	-	-	.89

*14"-24" are made from high strength ductile iron to ANSI A21.10, AWWA C110, WWP 250.

90° REDUCING ELBOW

ANSI B16.1 Class 125

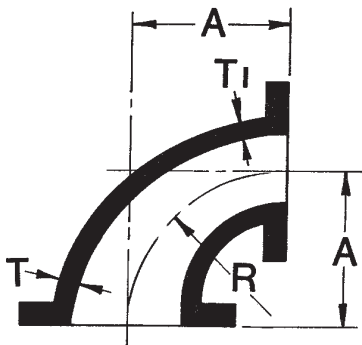

SERIES 10R

Size	Part No.	A	R	T	T1	Weight
3 x 2	10F-0302-G	5.5	4.0	.38	.31	19
3 x 2 1/2	10F-03025-G	5.5	4.0	.38	.31	22
4 x 2	10F-0402-G	6.5	4.0	.50	.31	29
4 x 2 1/2	10F-04025-G	6.5	4.0	.50	.31	31
4 x 3	10F-0403-G	6.5	4.5	.50	.38	33
5 x 4	10F-0504-G	7.5	5.0	.50	.50	48
6 x 3	10F-0603-G	8.0	6.0	.56	.38	45
6 x 4	10F-0604-G	8.0	6.0	.56	.50	55
6 x 5	10F-0605-G	8.0	6.0	.56	.50	65
8 x 4	10F-0804-G	9.0	7.0	.62	.50	75
8 x 5	10F-0805-G	9.0	7.0	.62	.56	80
8 x 6	10F-0806-G	9.0	7.0	.62	.56	85
10 x 4	10F-1004-G	11.0	9.0	.75	.50	110
10 x 6	10F-1006-G	11.0	9.0	.75	.56	135
10 x 8	10F-1008-G	11.0	9.0	.75	.62	150
12 x 4	10F-1204-G	12.0	10.0	.81	.50	140
12 x 6	10F-1206-G	12.0	10.0	.81	.56	160
12 x 8	10F-1208-G	12.0	10.0	.81	.62	180
12 x 10	10F-1210-G	12.0	10.0	.81	.75	210
14 x 12*	10F-1412-D	14.0	11.5	.66	.75	270
16 x 12*	10F-1612-D	15.0	12.5	.70	.75	310
16 x 14*	10F-1614-D	15.0	12.5	.70	.66	330

*14"-24" are made from high strength ductile iron to ANSI A21.10, AWWA C110, WWP 250.

ORDERS FAX 800-807-2214

90° LONG RADIUS ELBOW

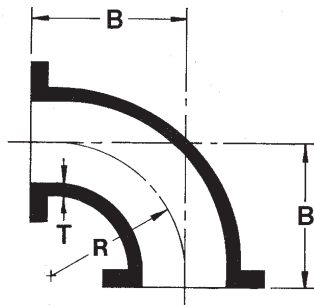

SERIES 15

Size	Part No.	B	R	T	Weight
3	15F-0303-G	7.5	6.0	.38	28
4	15F-0404-G	9.0	7.0	.50	48
6	15F-0606-G	11.5	9.5	.56	85
8	15F-0808-G	14.0	17.0	.62	145
10	15F-1010-G	16.5	14.0	.75	230
12	15F-1212-G	19.0	17.0	.81	350

Larger sizes thru 24" available upon request.

90° BASE ELBOW

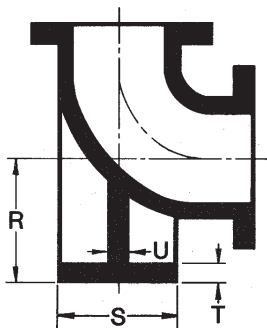

SERIES 16

Size	Part No.	R	S (Dia.)	T	U	Weight
3	16F-0303-G	4.0	5.0	.28	.50	36
4	16F-0404-G	5.5	6.0	.62	.50	55
6	16F-0606-G	7.0	7.0	.69	.62	85
8	16F-0808-G	8.38	9.0	.94	.88	145
10	16F-1010-G	9.75	9.0	.94	.88	210
12	16F-1212-G	11.25	11.0	1.0	1.0	300

Larger sizes thru 24" available upon request.

SIDE OUTLET 90° ELBOW

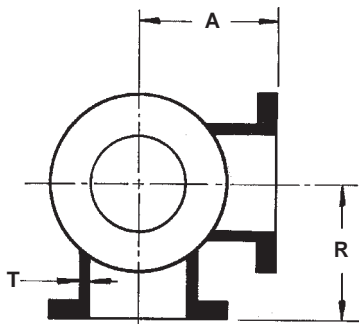

SERIES 18

Size	Part No.	A	R	T	Weight
4	18F-0404-G	6.5	6.5	.50	60
6	18F-0606-G	8.0	8.0	.56	95
8	18F-0808-G	9.0	9.0	.62	150
10	18F-1010-G	11.0	11.0	.75	235
12	18F-1212-G	12.0	12.0	.81	335

Larger sizes thru 24" available upon request.

TEES & CROSSES

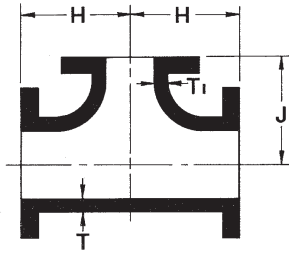

SERIES 20

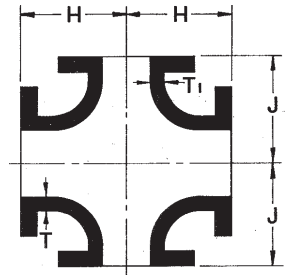

SERIES 35

Size	Part No.		H	J	T	T1	Weight	
	Tee	Cross					Tee	Cross
2	20F-0202-G	35F-0202-G	4.5	4.5	.31	.31	20	30
2 1/2	20F-025025-G	35F-025025-G	5.0	5.0	.31	.31	30	39
3 x 2	20F-0302-G	-	5.5	5.5	.38	.31	35	-
3 x 2 1/2	20F-03025-G	-	5.5	5.5	.38	.31	38	-
3	20F-0303-G	35F-0303-G	5.5	5.5	.38	.31	40	50
4 x 2	20F-0402-G	-	6.5	6.5	.50	.31	50	-
4 x 2 1/2	20F-04025-G	-	6.5	6.5	.50	.31	55	-
4 x 3	20F-0403-G	-	6.5	6.5	.50	.38	60	-
4	20F-0404-G	35F-0404-G	6.5	6.5	.50	.50	65	80
5	20F-0505-G	35F-0505-G	7.5	7.5	.50	.50	85	105
6 x 2	20F-0602-G	-	8.0	8.0	.56	.31	86	-
6 x 3	20F-0603-G	-	8.0	8.0	.56	.38	85	-
6 x 4	20F-0604-G	35F-0604-G	8.0	8.0	.56	.50	90	110
6	20F-0606-G	35F-0606-G	8.0	8.0	.56	.56	95	120
8 x 3	29F-0803-G	-	9.0	9.0	.62	.38	140	-
8 x 4	20F-0804-G	-	9.0	9.0	.62	.50	140	-
8 x 6	20F-0806-G	35F-0806-G	9.0	9.0	.62	.56	145	165
8	20F-0808-G	35F-0808-G	9.0	9.0	.62	.62	155	195
10 x 3	20F-1003-G	-	11.0	11.0	.75	.38	200	-
10 x 4	20F-1004-G	-	11.0	11.0	.75	.50	205	-
10 x 6	20F-1006-G	-	11.0	11.0	.75	.56	215	-
10 x 8	20F-1008-G	-	11.0	11.0	.75	.62	225	-
10	20F-1010-G	35F-1010-G	11.0	11.0	.75	.75	270	330
12 x 4	20F-1204-G	-	12.0	12.0	.81	.50	290	-
12 x 6	20F-1206-G	-	12.0	12.0	.81	.56	295	-
12 x 8	20F-1208-G	-	12.0	12.0	.81	.62	310	-
12 x 10	20F-1210-G	-	12.0	12.0	.81	.75	360	-
12	20F-1212-G	35F-1212-G	12.0	12.0	.81	.81	385	460
14*	20F-1414-D	35F-1414-D	14.0	14.0	.66	.66	435	-
16*	20F-1616-D	35F-1616-D	15.0	15.0	.70	.70	550	-
18*	20F-1818-D	35F-1818-D	16.5	16.5	.75	.75	665	-
20*	20F-2020-D	35F-2020-D	18.0	18.0	.80	.80	855	-
24*	20F-2424-D	35F-2424-D	22.0	22.0	.89	.89	1330	-

*14"~24" are made from high strength ductile iron to ANSI A21.10, AWWA C110, WWP 250.

REDUCING TEE (on Run and/or Branch)

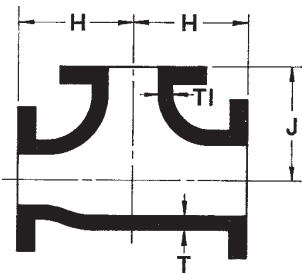

SERIES 26

Size	Part No.	H	J	T	T1	Weight
4 x 3 x 4	26F-0434-G	6.5	6.5	.50	.38	59
6 x 4 x 4	26F-0644-G	8.0	8.0	.56	.50	90
6 x 4 x 6	26F-0646-G	8.0	8.0	.56	.50	95
8 x 4 x 8	26F-0848-G	9.0	9.0	.62	.50	146
8 x 6 x 4	26F-0864-G	9.0	9.0	.62	.56	125
8 x 6 x 6	26F-0866-G	9.0	9.0	.62	.56	145
8 x 6 x 8	26F-0868-G	9.0	9.0	.62	.56	160
10 x 8 x 8	26F-1088-G	11.0	11.0	.75	.62	232
10 x 8 x 10	26F-10810-G	11.0	11.0	.75	.62	262
12 x 8 x 8	26F-1288-G	12.0	12.0	.81	.62	298
12 x 10 x 10	26F-121010-G	12.0	12.0	.81	.75	340
12 x 10 x 12	26F-121012-G	12.0	12.0	.81	.75	365

Larger sizes thru 24" available upon request.

BULLHEAD TEE

ANSI B16.1 Class 125

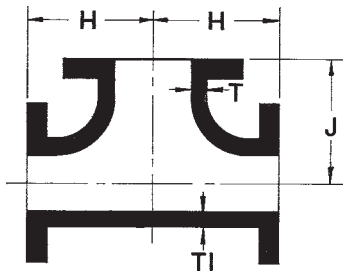

SERIES 27

Size	Part No.	H	J	T	T1	Weight
4 x 4 x 6	27F-0446-G	8.0	8.0	.50	.56	88
6 x 6 x 8	27F-0668-G	9.0	9.0	.56	.62	142
8 x 8 x 10	27F-08810-G	11.0	11.0	.62	.75	240
10 x 10 x 12	27F-101012-G	12.0	12.0	.75	.81	340

Larger sizes thru 24" available upon request.

TRUE WYES

ANSI B16.1 Class 125

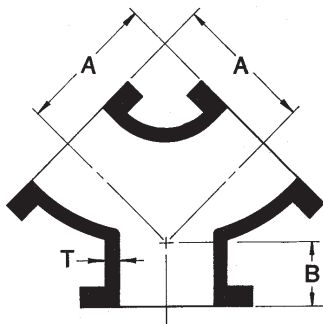

SERIES 32

Size	Part No.	A	B	T	Weight
4	32F-0404-G	6.5	3.0	.50	50
6	32F-0606-G	8.0	3.5	.56	80
8	32F-0808-G	9.0	4.5	.62	125

Larger sizes thru 24" available upon request.

LATERAL WYES

ANSI B16.1 Class 125

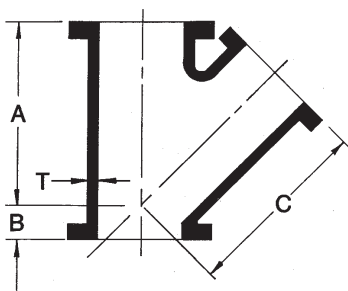

SERIES 30

Size	Part No.	A	B	C	T	T1	Weight
3	30F-0303-G	10.0	3.0	10.0	.38	-	45
4	30F-0404-G	12.0	3.0	12.0	.50	-	75
6	30F-0606-G	14.5	3.5	14.5	.56	-	120
6 x 4	30F-0604-G	14.5	3.5	14.5	.56	.50	105
8	30F-0808-G	17.5	4.5	17.5	.62	-	200
8 x 6	30F-0806-G	17.5	4.5	17.5	.62	.56	175
10	30F-1010-G	20.5	5.0	20.5	.75	-	335
12	30F-1212-G	24.5	5.5	24.5	.81	-	515

Larger sizes thru 24" available upon request.

CONCENTRIC & ECCENTRIC REDUCERS

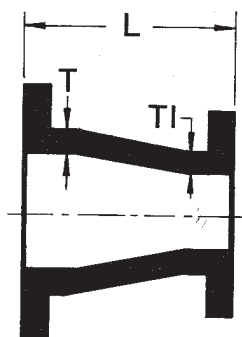

(CONCENTRIC)
SERIES 50

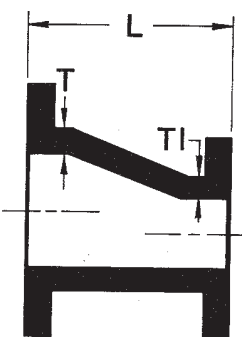

(ECCENTRIC)
SERIES 51

Size	Part No. (Concentric)	Part No. (Eccentric)	L	T	T1	Weight
2 x 1 1/2	50F-02025-G	-	5.5	.31	.30	12
2 1/2 x 2	50F-02502-G	-	5.5	.31	.31	14
3 x 1 1/2	50F-03015-G	-	6	.38	.30	15
3 x 2	50F-0302-G	51F-0302-G	6	.38	.31	16
3 x 2 1/2	50F-03025-G	51F-03025-G	6	.38	.31	20
4 x 2	50F-0402-G	51F-0402-G	7	.50	.31	25
4 x 2 1/2	50F-04025-G	51F-04025-G	7	.50	.31	28
4 x 3	50F-0403-G	51F-0403-G	7	.50	.38	30
5 x 2 1/2	50F-05025-G	51F-05025-G	8	.50	.31	31
5 x 3	50F-0503-G	51F-0503-G	8	.50	.38	32
5 x 4	50F-0504-G	51F-0504-G	8	.50	.50	39
6 x 2 1/2	50F-06025-G	51F-06025-G	9	.56	.31	38
6 x 3	50F-0603-G	51F-0603-G	9	.56	.38	40
6 x 4	50F-0604-G	51F-0604-G	9	.56	.50	45
6 x 5	50F-0605-G	51F-0605-G	9	.56	.50	50
8 x 4	50F-0804-G	51F-0804-G	11	.62	.50	65
8 x 5	50F-0805-G	51F-0805-G	11	.62	.50	70
8 x 6	50F-0806-G	51F-0806-G	11	.62	.56	75
10 x 4	50F-1004-G	51F-1004-G	12	.75	.50	85
10 x 5	50F-1005-F	51F-1005-G	12	.75	.50	88
10 x 6	50F-1006-G	51F-1006-G	12	.75	.56	90
10 x 8	50F-1008-G	51F-1008-G	12	.75	.62	110
12 x 4	50F-1204-G	51F-1204-G	14	.81	.50	120
12 x 6	50F-1206-G	51F-1206-G	14	.81	.56	130
12 x 8	50F-1208-G	51F-1208-G	14	.81	.62	145
12 x 10	50F-1210-G	51F-1210-G	14	.81	.75	170
14 x 6*	50F-1406-D	51F-1406-D	16	.66	.55	155
14 x 8*	50F-1408-D	51F-1408-D	16	.66	.60	175
14 x 10*	50F-1410-D	51F-1410-D	16	.66	.68	190
14 x 12*	50F-1412-D	51F-1412-D	16	.66	.75	220
16 x 6*	50F-1606-D	51F-1606-D	18	.70	.55	190
16 x 8*	50F-1608-D	51F-1608-D	18	.70	.60	210
16 x 10*	50F-1610-D	51F-1610-D	18	.70	.68	235
16 x 12*	50F-1612-D	51F-1612-D	18	.70	.75	265
16 x 14*	50F-1614-D	51F-1614-D	18	.70	.66	280
18 x 8*	50F-1808-D	51F-1808-D	19	.75	.60	240
18 x 10*	50F-1810-D	51F-1810-D	19	.75	.68	265
18 x 12*	50F-1812-D	51F-1812-D	19	.75	.75	295
18 x 14*	50F-1814-D	51F-1814-D	19	.75	.66	310
18 x 16*	50F-1816-D	51F-1816-D	19	.75	.70	340
20 x 10*	50F-2010-D	51F-2010-D	20	.80	.68	310
20 x 12*	50F-2012-D	51F-2012-D	20	.80	.75	345
20 x 14*	50F-2014-D	51F-2014-D	20	.80	.66	355
20 x 16*	50F-2016-D	51F-2016-D	20	.80	.70	390
20 x 18*	50F-2018-D	51F-2018-D	20	.80	.75	410
24 x 12*	50F-2412-D	51F-2412-D	24	.89	.75	480
24 x 14*	50F-2414-D	51F-2414-D	24	.89	.66	490
24 x 16*	50F-2416-D	51F-2416-D	24	.89	.70	525
24 x 18*	50F-2418-D	51F-2418-D	24	.89	.75	550
24 x 20*	50F-2420-D	51F-2420-D	24	.89	.80	590

*14"~24" are made from high strength ductile iron to ANSI A21.10, AWWA C110, WWP 250.

STANDARD COMPANION FLANGE (Cast Iron)

ANSI B16.1 Class 125

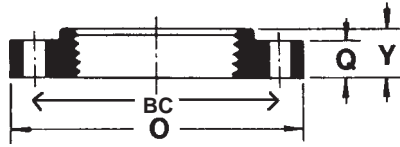

SERIES 306

Nominal Size	Product No.	BC	O	Q	Y	Bolt Holes		Wgt.
						No.	Size	
1	306-100-0425	3.12	4 1/4	7/16	11/16	4	0.62	1.75
1 1/4	306-125-0463	3.50	4 5/8	1/2	13/16	4	0.62	2.00
1 1/2	306-150-0500	3.88	5	9/16	7/8	4	0.62	2.25
2	306-200-0600	4.75	6	5/8	1	4	0.75	4.00
2 1/2	306-250-0700	5.50	7	11/16	1 1/8	4	0.75	6.00
3	306-300-0750	6.00	7 1/2	3/4	1 3/16	4	0.75	7.63
3 1/2	306-350-0850	7.00	8 1/2	13/16	1 1/4	8	0.75	9.50
4	306-400-0900	7.50	9	15/16	1 5/16	8	0.75	11.75
5	306-500-1000	8.50	10	15/16	1 7/16	8	0.88	14.00
6	306-600-1100	9.50	11	1	1 9/16	8	0.88	16.50
8	306-800-1350	11.75	13 1/2	1 1/8	1 3/4	8	0.88	26.00
10	306-1000-1600	14.25	16	1 3/16	1 15/16	12	1.00	38.00
12	306-1200-1900	17.00	19	1 1/4	2 3/16	12	1.00	51.00

Larger sizes thru 24" available upon request.

ANSI B16.1 Class 125

REDUCING COMPANION FLANGE (Cast Iron)

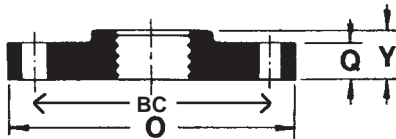

SERIES 316

Nominal Size		Product No.	Thread Size	BC	O	Q	Y	Bolt Holes		Weight
Pipe x O.D.	Flg. x Pipe							No.	Size	
1 x 5	1 1/2 x 1	316-100-0500	1				11/16	4	0.62	2.75
1 1/4 x 5	1 1/2 x 1 1/4	316-125-0500	1 1/4	3.88	5	9/16	13/16	4	0.62	2.50
1 x 6	2 x 1	316-100-0600	1				11/16			5.00
1 1/4 x 6	2 x 1 1/4	316-125-0600	1 1/4	4.75	6	5/8	13/16	4	0.75	4.75
1 1/2 x 6	2 x 1 1/2	316-150-0600	1 1/2				7/8			4.50
1 1/2 x 7	2 1/2 x 1 1/2	316-150-0700	1 1/2	5.50	7	11/16	7/8	4	0.75	7.00
2 x 7	2 1/2 x 2	316-200-0700	2				1			6.75
1 x 7 1/2	3 x 1	316-100-0750	1				13/16			9.00
1 1/2 x 7 1/2	3 x 1 1/2	316-150-0750	1 1/2	6.00	7 1/2	3/4	7/8	4	0.75	8.75
2 x 7 1/2	3 x 2	316-200-0750	2				1			8.50
2 1/2 x 7 1/2	3 x 2 1/2	316-250-0750	2 1/2				1 1/8			8.00
1 1/2 x 9	4 x 1 1/2	316-150-0900	1 1/2				1			14.75
2 x 9	4 x 2	316-200-0900	2				1			14.00
2 1/2 x 9	4 x 2 1/2	316-250-0900	2 1/2	7.50	9	15/16	1 1/8	8	0.75	13.50
3 x 9	4 x 3	316-300-0900	3				1 3/16			12.75
2 x 10	5 x 3	316-300-1000	3	8.50	10	15/16	1 3/16	8	0.88	17.00
4 x 10	5 x 4	316-400-1000	4				1 5/16			16.00
1 1/2 x 11	6 x 1 1/2	316-150-1100	1 1/2				1 1/16			27.00
2 x 11	6 x 2	316-200-1100	2				1 1/16			26.00
2 1/2 x 11	6 x 2 1/2	316-250-1100	2 1/2	9.50	11	1	1 1/8	8	0.88	25.00
3 x 11	6 x 3	316-300-1100	3				1 3/16			23.00
4 x 11	6 x 4	316-400-1100	4				1 5/16			21.00
5 x 11	6 x 5	316-500-1100	5				1 7/16			19.00
2 x 13 1/2	8 x 2	316-200-1350	2				1 3/16			44.00
3 x 13 1/2	8 x 3	316-300-1350	3				1 3/16			40.00
4 x 13 1/2	8 x 4	316-400-1350	4	11.75	13 1/2	1 1/8	1 5/16	8	0.88	37.00
5 x 13 1/2	8 x 5	316-500-1350	5				1 7/16			34.00
6 x 13 1/2	8 x 6	316-600-1350	6				1 9/16			31.00
2 x 16	10 x 2	316-200-1600	2				1 15/16			61.00
6 x 16	10 x 6	316-600-1600	6	14.25	16	1 3/16	1 15/16	12	1.00	53.00
8 x 16	10 x 8	316-800-1600	8				1 15/16			50.00
2 x 19	12 x 2	316-200-1900	2				2 3/16			84.00
8 x 19	12 x 8	316-800-1900	8	17.00	19	1 1/4	2 3/16	12	1.00	81.00
10 x 19	12 x 10	316-1000-1900	10				2 3/16			72.00

Larger sizes thru 24" available upon request.

ORDERS FAX 800-807-2214

REDI-FLANGE™

ANSI B16.1 Class 125
ANSI B16.5 Class 150

No Welding!
No Threading!

STANDARDS:

Ductile Iron - ASTM A536
Grade 65-45-12. Drilling to
ANSI B16.1 - 125 lb.
ANSI B16.5 - 150 lb.

SET SCREW: AISI
steel. Tensile 160,000
psi minimum.

GASKET: SBR (BUNA-N).

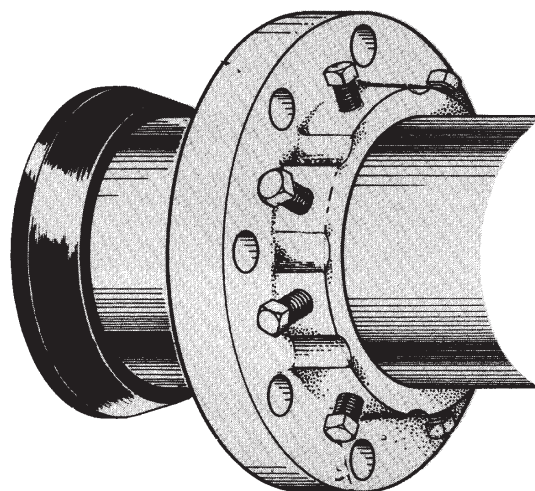

HYDROSTATIC TEST PRESSURE:

MODEL - RFC-2 - 125 lb./150 lb.
2 in. - 8 in. 600 psi
10 in. - 12 in. 525 psi

MODEL - RFC-4 - 125 lb./150 lb.
3 in. - 12 in. 750 psi
14 in. - 24 in. 300 psi

The *Redi-Flange™* joins valves, fittings and equipment with integral flanged ends to plain end pipe, without the need of pipe end preparation. Absolutely no threading, welding, or grooving is necessary. The working principle of the *Redi-Flange™* is relatively simple. Slide the flange over plain end pipe and follow it with a standard mechanical joint gasket. When the *Redi-Flange™* is brought to mate against an existing flange, and the flange bolts are tightened, a compression type seal is created against the mating flange and pipe surface. End restraint is provided when the set screws are tightened.

Nom. Pipe Size	Part No.	D.I. Pipe O.D. RFC-2-D	Steel Pipe O.D. RFC-2-S	Flange O.D.	Bolt Circle	Bolt Hole Dia.	Set Screws		Wgt. Approx.
							No.	Size	
2	RFC-201	2.38	2.50	6	4 3/4	3/4	2	1/2 x 1	3.5
2 1/2	RFC-202	-	2.88	7	5 1/2	3/4	4	1/2 x 1	4
3	RFC-203	3.96	3.50	7 1/2	6	3/4	4	1/2 x 1	5
4	RFC-204	4.80	4.50	9	7 1/2	3/4	4	1/2 x 1	8
5	RFC-205	-	5.56	10	8 1/2	7/8	8	1/2 x 1	9
6	RFC-206	6.90	6.625	11	9 1/2	7/8	8	1/2 x 1	10
8	RFC-208	9.05	8.625	13 1/2	11 3/4	7/8	8	5/8 x 1 1/4	17
10	RFC-210	11.10	10.75	16	14 1/4	1	12	5/8 x 1 1/4	22
12	RFC-212	13.20	12.75	19	17	1	12	5/8 x 1 1/4	31

Nom. Pipe Size	Part No.	D.I. Pipe O.D. RFC-4-D	Steel Pipe O.D. RFC-4-S	Flange O.D.	Bolt Circle	Boly Hole Dia.	Set Screws		Wgt. Approx.
							No.	Size	
3	RFC-403	3.96	3.50	7 1/2	6	3/4	4	1/2 x 1	8
4	RFC-404	4.80	4.50	9	7 1/2	3/4	4	1/2 x 1	11
6	RFC-406	6.90	6.625	11	9 1/2	7/8	8	5/8 x 1 1/4	14
8	RFC-408	9.05	8.625	13 1/2	11 3/4	7/8	8	5/8 x 1 1/4	21
10	RFC-410	11.10	10.75	16	14 1/4	1	12	5/8 x 1 1/4	38
12	RFC-412	13.20	12.75	19	17	1	12	5/8 x 1 1/4	56
14	RFC-414	15.30	NA	21	18 3/4	1 1/8	12	5/8 x 1 1/4	70
16	RFC-416	17.40	NA	23 1/2	21 1/4	1 1/8	16	5/8 x 1 1/4	79
18	RFC-418	19.50	NA	25	22 3/4	1 1/4	16	3/4 x 2	90
20	RFC-420	21.60	NA	27 1/2	25	1 1/4	20	3/4 x 2	145
24	RFC-424	25.80	NA	32	29 1/2	1 3/8	20	3/4 x 2	175

COMPACT FLANGE REDUCER Class 125/150 Flanges

Mates with ANSI Class 125/150 flange drillings

Material: Ductile Iron
ASTM A536 or ASTM A36
Steel

TYPE A

TYPE B

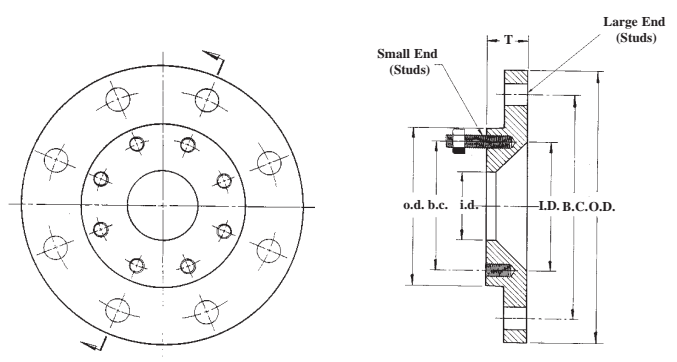
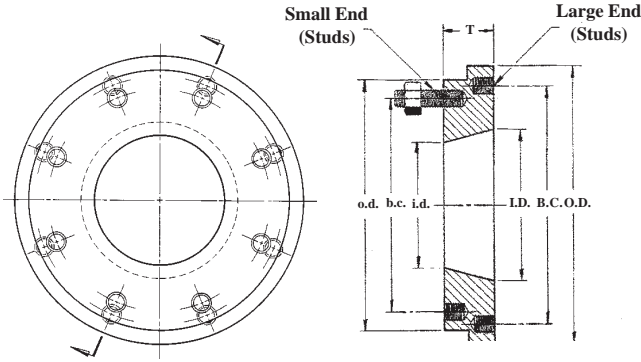

Flange Sizes	Part No.	Large End			Small End			T	Type	Large End Studs		Small End Studs	
		I.D.	O.D.	B.C.	i.d.	o.d.	b.c.			Qty.	Size	Qty.	Size
2 x 1 1/2	740-110-100	2.00	6.00	4.75	1.50	6.00	3.88	1.50	A	4	5/8 x 2 1/2	4	1/2 x 2 1/2
2 1/2 x 1 1/2	740-120-100	2.50	7.00	5.50	1.50	6.00	3.88	1.50	A	4	5/8 x 2 1/2	4	1/2 x 2 1/2
2 1/2 x 2	740-120-110	2.50	7.00	5.50	2.00	6.00	4.75	1.50	A	4	5/8 x 2 1/2	4	5/8 x 2 1/2
3 x 1 1/2	740-130-100	3.00	7.50	6.00	1.50	6.00	3.88	1.50	A	4	5/8 x 2 1/2	4	1/2 x 2 1/2
3 x 2	740-130-110	3.00	7.50	6.00	2.00	6.00	4.75	1.50	A	4	5/8 x 3	4	5/8 x 3
3 x 2 1/2	740-130-120	3.00	7.50	6.00	2.50	7.00	5.50	1.50	A	4	5/8 x 2 1/2	4	5/8 x 2 1/2
4 x 2	740-140-110	4.00	9.00	7.50	2.00	6.00	4.75	1.50	A	8	5/8 x 2 1/2	4	5/8 x 2 1/2
4 x 2 1/2	740-140-120	4.00	9.00	7.50	2.50	7.00	5.50	1.50	A	8	5/8 x 2 1/2	4	5/8 x 2 1/2
4 x 3	740-140-130	4.00	9.00	7.50	3.00	7.50	6.00	1.50	A	8	5/8 x 2 1/2	4	5/8 x 2 1/2
6 x 2 1/2	790-160-120	6.00	11.00	9.50	2.50	7.00	5.50	1.50	B	-	-	8	3/4 x 3 1/2
6 x 3	790-160-130	6.00	11.00	9.50	3.00	7.50	6.00	1.50	B	-	-	8	3/4 x 3 1/2
6 x 4	740-160-140	6.00	11.00	9.50	4.00	9.00	7.50	2.00	A	8	3/4 x 3	8	5/8 x 2 1/2
6 x 5	740-160-150	6.00	11.00	9.50	5.00	10.00	8.50	2.00	A	8	3/4 x 3	8	3/4 x 3
8 x 4	790-180-140	8.00	13.50	11.75	4.00	9.00	7.50	2.00	B	-	-	8	3/4 x 3 1/2
8 x 5	740-180-150	8.00	13.50	11.75	5.00	10.00	8.50	2.00	A	8	3/4 x 3 1/2	8	3/4 x 3
8 x 6	740-180-160	8.00	13.50	11.75	6.00	11.00	9.50	2.00	A	8	3/4 x 3 1/2	8	3/4 x 3
10 x 2	790-200-110	10.00	16.00	14.25	2.00	6.00	4.75	1.50	B	-	-	4	5/8 x 2 1/2
10 x 4	790-200-140	10.00	16.00	14.25	4.00	9.00	7.50	2.00	B	-	-	12	7/8 x 4
10 x 5	790-200-150	10.00	16.00	14.25	5.00	10.00	8.50	2.00	B	-	-	12	7/8 x 4
10 x 6	740-200-160	10.00	16.00	14.25	6.00	11.00	9.50	2.00	A	12	7/8 x 3 3/4	8	3/4 x 3
10 x 8	740-200-180	10.00	16.00	14.25	8.00	13.50	11.75	2.00	A	12	7/8 x 3 3/4	8	3/4 x 3 1/2
12 x 4	790-220-140	12.00	19.00	17.00	4.00	9.00	7.50	2.00	B	-	-	12	7/8 x 4
12 x 6	790-220-160	12.00	19.00	17.00	6.00	11.00	9.50	2.00	B	-	-	12	7/8 x 4
12 x 8	740-220-180	12.00	19.00	17.00	8.00	13.50	11.75	2.00	A	12	7/8 x 3 3/4	8	3/4 x 3 1/2
12 x 10	740-220-200	12.00	19.00	17.00	10.00	16.00	14.25	2.00	A	12	7/8 x 3 3/4	12	7/8 x 3 3/4
14 x 6	790-240-160	14.00	21.00	18.75	6.00	11.00	9.50	2.50	B	-	-	12	1 x 4 1/2
14 x 8	790-240-180	14.00	21.00	18.75	8.00	13.50	11.75	2.50	B	-	-	12	1 x 4 1/2
14 x 10	740-240-200	14.00	21.00	18.75	10.00	16.00	14.25	2.50	A	12	1 x 4	12	7/8 x 3 1/2
14 x 12	740-240-220	14.00	21.00	18.75	12.00	19.00	17.00	2.50	A	12	1 x 4	12	7/8 x 3 1/2
16 x 6	790-260-160	16.00	23.50	21.25	3.00	11.00	9.50	2.50	B	-	-	16	1 x 4 1/2
16 x 8	790-260-180	16.00	23.50	21.25	8.00	13.50	11.75	2.50	B	-	-	16	1 x 4 1/2
16 x 10	790-260-200	16.00	23.50	21.25	10.00	16.00	14.25	2.50	B	-	-	16	1 x 4
16 x 12	740-260-220	16.00	23.50	21.25	12.00	19.00	17.00	2.50	A	16	1 x 4	12	7/8 x 3 1/2
16 x 14	740-260-240	16.00	23.50	21.25	14.00	21.00	18.75	2.50	A	16	1 x 4	12	1 x 4

BLIND FLANGES

ANSI B16.1 Class 125

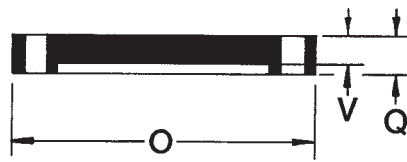

SERIES 60 (1"-10")

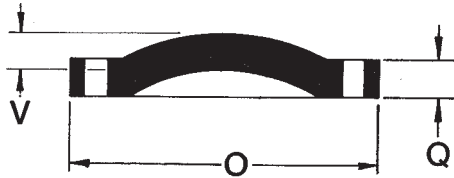

SERIES 60 (12")

Size	Part No.	O	Q	V	Weight
1	60F-0100-G	4.25	.44	.38	2
1 1/4	60F-0125-G	4.62	.50	.44	2.25
1 1/2	60F-0150-G	5.00	.56	.50	3.75
2	60F-0200-G	6.00	.62	.62	5
2 1/2	60F-0250-G	7.00	.68	.62	7
3	60F-0300-G	7.50	.75	.69	9
3 1/2	60F-0350-G	8.50	.81	.75	14
4	60F-0400-G	9.00	.94	.88	16
5	60F-0500-G	10.00	.94	.88	18
6	60F-0600-G	11.00	1.00	.94	25
8	60F-0800-G	13.50	1.12	1.06	42
10	60F-1000-G	16.00	1.19	1.12	62
12	60F-1200-G	19.00	1.25	.81	85
14*	60F-1400-D	21.00	1.38	.88	120
16*	60F-1600-D	23.50	1.44	1.00	145
18*	60F-1800-D	25.00	1.56	1.06	185
20*	60F-2000-D	27.50	1.69	1.12	245
24*	60F-2400-D	32.00	1.88	1.25	370

*14"-24" are made from high strength ductile iron to ANSI A21.10, AWWA C110, WWP 250.

FLANGE CONVERTERS

ANSI B16.1 Class 125

Class 125/150

Class 250/300

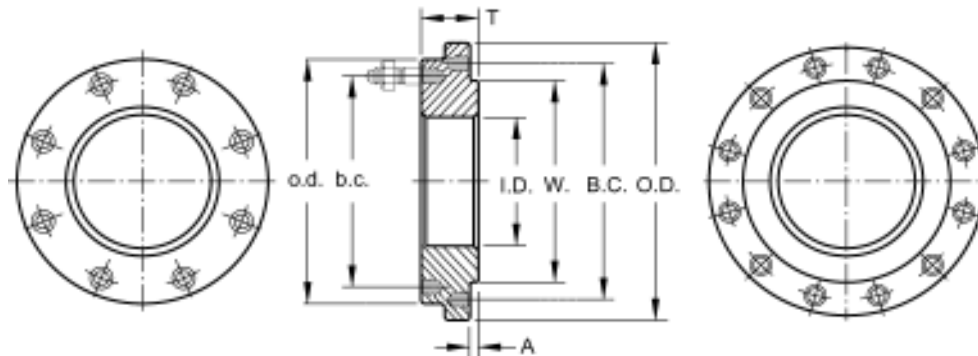

Part No.	CLASS 125/150					CLASS 250/300						Weight	
	Flange Size/I.D.	o.d.	b.c.	No. of Bolt Holes	Stud Bolt Size	W	B.C.	O.D.	A	T	No. of Bolt Holes		Stud Bolt Size
840-140	4	9	7.5	8	5/8 x 2 1/2	6.94	7.88	10	0.06	2	8	3/4 x 3 1/2	28
840-150	5	10	8.5	8	3/4 x 3	8.31	9.25	11	0.06	2	8	3/4 x 3 1/2	32
840-160	6	11	9.5	8	3/4 x 3	9.69	10.62	12.5	0.06	2	12	3/4 x 3 1/2	42
840-180	8	13.5	11.75	8	3/4 x 3 1/2	11.94	13	15	0.06	2 1/4	12	7/8 x 4	66
840-200	10	16	14.25	12	7/8 x 3 1/2	14.06	15.25	17.5	0.06	2 3/4	16	1 x 4 1/2	100
840-220	12	19	17	12	7/8 x 3 1/2	16.44	17.75	20.5	0.06	2 3/4	16	1 1/8 x 5	160

ORDERS FAX 800-807-2214

SEAL-TITE FLANGE GASKET

ANSI B16.1 Class 125

Low Torque!

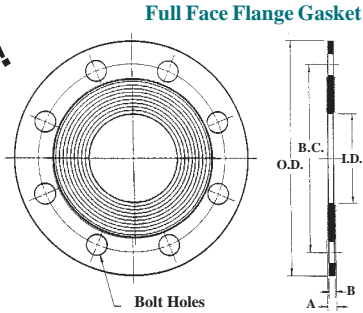

Ring Type Flange Gasket

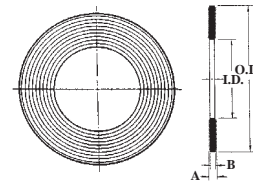

Serrated Face!

Material: Buna-N

Nominal Size	Part No. (Full Face)	Part No. (Ring)	ID	OD (Full Face)	OD (Ring)	A	B	BC (Full Face)	Box Quantity (Full Face)	Box Quantity (Ring)
2	FFG-050-150	RG-050-100	2.15	6.00	3.90	5/32	1/8	4.75	25	25
2 1/2	FFG-065-175	RG-065-120	2.73	7.00	4.70	5/32	1/8	5.50	25	25
3	FFG-080-188	RG-080-132	3.20	7.50	5.15	5/32	1/8	6.00	25	25
4	FFG-100-210	RG-100-162	3.98	9.00	6.30	5/32	1/8	7.50	25	25
5	FFG-125-250	RG-125-194	5.07	10.00	7.60	5/32	1/8	8.50	25	25
6	FFG-150-275	RG-150-218	6.01	11.00	8.50	5/32	1/8	9.50	25	25
8	FFG-200-340	RG-200-272	8.11	13.50	10.60	5/32	1/8	11.75	25	25
10	FFG-250-400	RG-250-328	10.06	16.00	12.80	5/32	1/8	14.25	25	25
12	FFG-300-475	RG-300-378	12.09	19.00	14.75	5/32	1/8	17.00	25	25
14	FFG-350-525	RG-350-445	14.12	21.00	17.15	5/32	1/8	18.75	20	25
16	FFG-400-588	RG-400-510	16.19	23.50	19.90	5/32	1/8	21.25	20	25
18	FFG-450-625	RG-450-542	18.25	25.00	21.15	5/32	1/8	22.75	20	20
20	FFG-500-688	RG-500-606	20.28	27.50	23.60	5/32	1/8	25.00	20	20
24	FFG-600-800	RG-600-717	24.34	32.00	27.95	5/32	1/8	29.50	20	20

FLAT FLANGE GASKET

Full Face

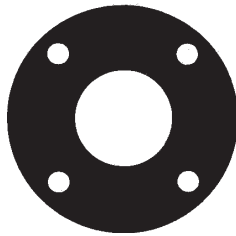

Ring Type

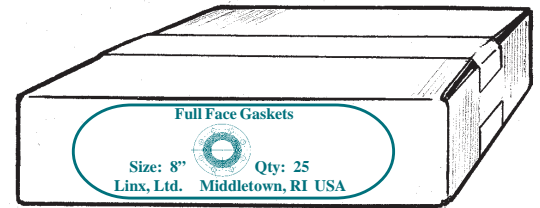

Material: Red Rubber
Non-Asbestos

Nominal Size	Part No. (Full Face)	Part No. (Ring)	OD (Full Face)	OD (Ring)	Thickness	Bolt Circle (Full Face)	Box Quantity (Full Face)	Box Quantity (Ring)
2	FFF-050-150	FRG-050-100	6.00	3.90	1/8	4.75	25	25
2 1/2	FFF-065-175	FRG-065-120	7.00	4.70	1/8	5.50	25	25
3	FFF-080-188	FRG-080-132	7.50	5.15	1/8	6.00	25	25
4	FFF-100-210	FRG-100-162	9.00	6.30	1/8	7.50	25	25
5	FFF-125-250	FRG-125-194	10.00	7.60	1/8	8.50	25	25
6	FFF-150-275	FRG-150-218	11.00	8.50	1/8	9.50	25	25
8	FFF-200-340	FRG-200-272	13.50	10.60	1/8	11.75	25	25
10	FFF-250-400	FRG-250-328	16.00	12.80	1/8	14.25	25	25
12	FFF-300-475	FRG-300-378	19.00	14.75	1/8	17.00	25	25
14	FFF-350-525	FRG-350-445	21.00	17.15	1/8	18.75	20	25
16	FFF-400-588	FRG-400-510	23.50	19.90	1/8	21.25	20	25
18	FFF-450-625	FRG-450-542	25.00	21.15	1/8	22.75	20	20
20	FFF-500-688	FRG-500-606	27.50	23.60	1/8	25.00	20	20
24	FFF-600-800	FRG-600-717	32.00	27.95	1/8	29.50	20	20

ORDERS FAX 800-807-2214

Bolt and Nut Packs for Class 125/150 Flanges

ANSI B16.1 Class 125
ANSI B16.5 Class 250

Heavy Hex Head Bolts (ANSI B18.2.1/ASTM-A307 Grade B)
Heavy Hex Nuts (ANSI B18.2.2/ASTM-A563 Grade A)

Part No.	Class 125/150 Flange Size	Bolt Diameter and Length	No. of Bolts per Poly Bag	Master Box (Qty. of Sets)	Master Box Weight (Lbs.)
	2				
FBZ03	2 1/2	5/8 x 2 1/2	4	32	50
	3				
FBZ04	4	5/8 x 3	8	16	55
	5				
FBZ08	6	3/4 x 3 1/2	8	8	50
	8				
FBZ12	10	7/8 x 4	12	4	55
	12				
FBZ14	14	1 x 4 1/2	12	2	40
FBZ16	16	1 x 4 1/2	16	2	52
FBZ18	18	1 1/8 x 5	16	1	37
FBZ20	20	1 1/8 x 5	20	1	44
FBZ24	24	1 1/4 x 5 1/2	20	1	70

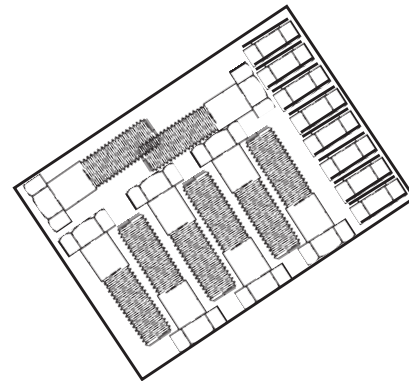

Available-plain, zinc plated, hot dipped galvanized, and type 304 stainless steel.

FLANGE ACCESSORY PACKS

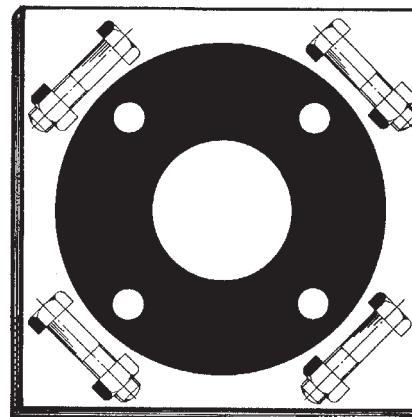
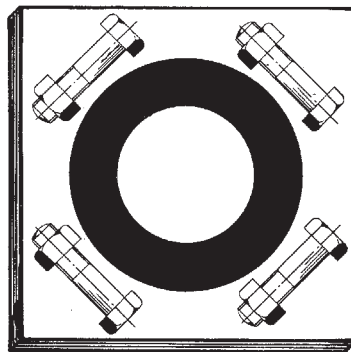

Class 125/150 Flange Size	1/8" Full Face Seal-Tite (Serrated)	1/8" Ring Type Seal-Tite (Serrated)	1/8" Full Face Red Rubber	1/8" Ring Type Red Rubber	1/8" Full Face Non-Asbestos	1/8" Ring Type Non-Asbestos
2	FBR-020-*	RBP-020-*	FRP-020-*	RRP-020-*	FNP-020-*	RNP-020-*
2 1/2	FBR-020-025-	RBP-020-025-	FRP-020-025-	RRP-020-025-	FNP-020-025-	RNP-020-025-
3	FBR-030-	RBP-030-	FRP-030-	RRP-030-	FNP-030-	RNP-030-
4	FBR-040-	RBP-040-	FRP-040-	RRP-040-	FNP-040-	RNP-040-
5	FBR-050-	RBP-050-	FRP-050-	RRP-050-	FNP-050-	RNP-050-
6	FBR-060-	RBP-060-	FRP-060-	RRP-060-	FNP-060-	RNP-060-
8	FBR-080-	RBP-080-	FRP-080-	RRP-080-	FNP-080-	RNP-080-
10	FBR-100-	RBP-100-	FRP-100-	RRP-100-	FNP-100-	RNP-100-
12	FBR-120-	RBP-120-	FRP-120-	RRP-120-	FNP-120-	RNP-120-
14	FBR-140-	RBP-140-	FRP-140-	RRP-140-	FNP-140-	RNP-140-
16	FBR-160-	RBP-160-	FRP-160-	RRP-160-	FNP-160-	RNP-160-
18	FBR-180-	RBP-180-	FRP-180-	RRP-180-	FNP-180-	RNP-180-
20	FBR-200-	RBP-200-	FRP-200-	RRP-200-	FNP-200-	RNP-200-
24	FBR-240-	RBP-240-	FRP-240-	RRP-240-	FNP-240-	RNP-240-

Zinc plated bolts and nuts.

ORDERS FAX 800-807-2214

FLANGE DETAILS - Class 250

ANSI B16.1 Class 250

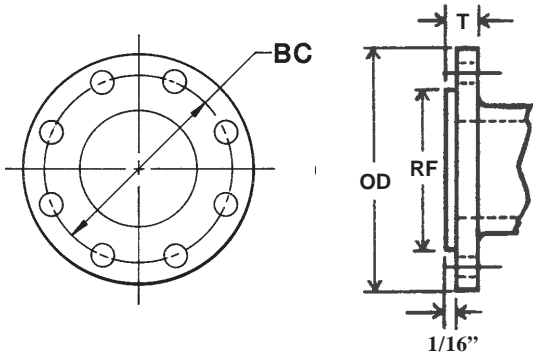

Size	OD	T	RF	BC	Bolt Hole Dia.	Bolt Dia. & Length	No. of Bolts
3	8 1/4	1 3/16	5 11/16	6 5/8	7/8	3/4 x 3 1/2	8
4	10	1 3/4	6 15/16	7 7/8	7/8	3/4 x 3 3/4	8
5	11	1 7/8	8 5/16	9 1/4	7/8	3/4 x 4	8
6	12 1/2	1 15/16	9 11/16	10 5/8	7/8	3/4 x 4	12
8	15	2 3/16	11 15/16	13	1	7/8 x 4 1/4	12
10	17 1/2	2 3/8	14 1/16	15 1/4	1 1/8	1 x 5 1/4	16
12	20 1/2	2 9/16	16 7/16	17 3/4	1 1/4	1 1/8 x 5 1/2	16

All dimensional data in inches and lbs.

ELBOWS

ANSI B16.1 Class 250

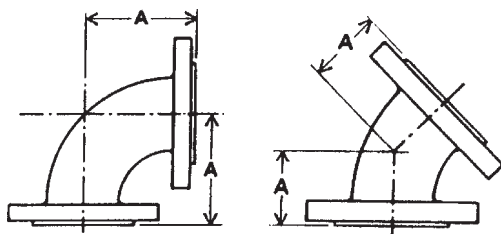

Size	90° Elbow			45° Elbow		
	Part No.	A	Wgt.	Part No.	A	Wgt.
3	100F-0303-G	6	40	110F-0303-G	3 1/2	35
4	100F-0404-G	7	66	110F-0404-G	4 1/2	60
6	100F-0606-G	8 1/2	124	110F-0606-G	5 1/2	103
8	100F-0808-G	10	192	110F-0808-G	6	158
10	100F-1010-G	11 1/2	311	110F-1010-G	7	247
12	100F-1212-G	13	430	110F-1212-G	8	355

90° REDUCING ELBOW

ANSI B16.1 Class 250

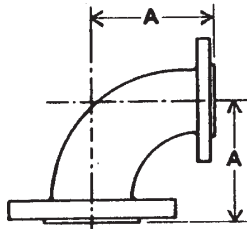

Size	Part No.	A	Weight
6 x 4	100F-0604-G	8 1/2	95
8 x 6	100F-0806-G	10	161
10 x 8	100F-1008	11 1/2	240

TEES

ANSI B16.1 Class 250

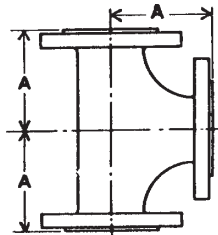

Size	Part No.	A	Weight
4	200F-0404-G	7	98
6	200F-0606-G	8 1/2	184
8	200F-0808-G	10	280
10	200F-1010-G	11 1/2	435
12	200F-1212-G	13	599

REDUCING TEES

ANSI B16.1 Class 250



Size	Part No.	A	Weight
6 x 6 x 4	260F-060604-G	8 1/2	150
8 x 8 x 6	260F-080806-G	10	246

REDUCERS

ANSI B16.1 Class 250

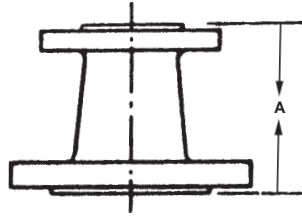

Size	Part No.	A	Weight
4 x 3	500F-0403-G	7	40
6 x 4	500F-0604-G	9	77
6 x 5	500F-0605-G	9	85
8 x 6	500F-0806-G	11	142
10 x 8	500F-1008-G	12	196

CROSSES

ANSI B16.1 Class 250

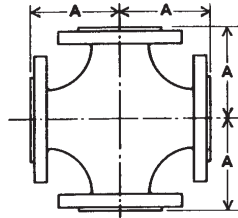

Size	Part No.	A	Weight
4	350F-0404-G	7	139
6	350F-0606-G	8 1/2	228
8	350F-0808-G	10	370

BLIND FLANGES

ANSI B16.1 Class 250

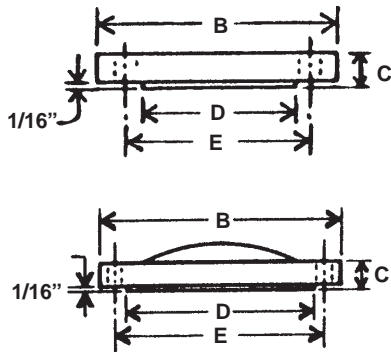

Nominal Pipe Size	Flange Size	Part No.	C	B	D	E	Weight
3	3 x 8 1/4	600F-0303-G	1 3/16	8 1/4	5 11/16	6 5/8	14
4	4 x 10	600F-0404-G	1 1/4	10	6 15/16	7 7/8	25
6	6 x 12 1/2	600F-0606-G	1 7/16	12 1/2	9 11/16	10 5/8	43
8	8 x 15	600F-0808-G	1 5/8	15	11 15/16	13	69
10	10 x 17 1/2	600F-1010-G	1 7/8	17 1/2	14 1/16	15 1/4	100
12	12 x 20 1/2	600F-1212-G	2	20 1/2	16 7/16	17 3/4	148

Dished faces for use with 10\" and 12\" extra heavy Blind Flanges.

THREADED FLANGES

ANSI B16.1 Class 250

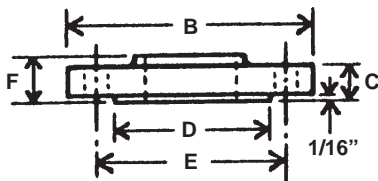

Nominal Pipe Size	Flange Size	Part No.	C	B	D	E	F	Weight
3	3 x 8 1/4	760F-0303-G	1 1/8	8 1/4	5 11/16	6 5/8	1 11/16	12
4	4 x 10	760F-0404-G	1 1/4	10	6 15/16	7 7/8	1 3/4	21
6	6 x 12 1/2	760F-0606-G	1 7/16	12 1/2	9 11/16	10 5/8	1 15/16	33
8	8 x 15	760F-0808-G	1 5/8	15	11 15/16	13	2 3/16	51
10	10 x 17 1/2	760F-1010-G	1 7/8	17 1/2	14 1/16	15 1/4	2 3/8	77
12	12 x 20 1/2	760F-1212-G	2	20 1/2	16 7/16	17 3/4	2 9/16	103

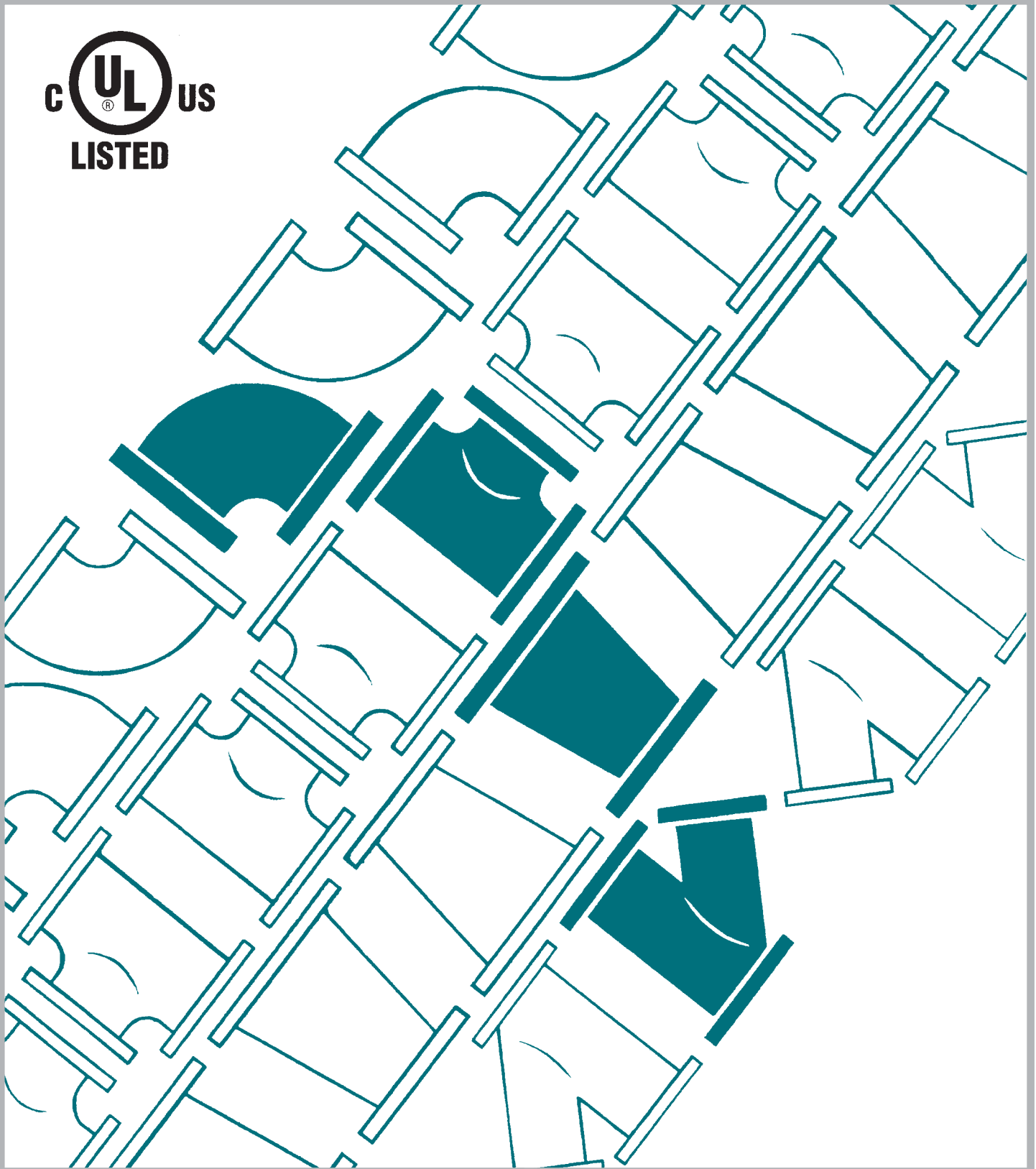

Napac, Inc.
229 Southbridge Street
Worcester, Massachusetts 01608 USA
Tel.: 800-807-2215
Fax: 800-807-2214